

PRODUCT DATA SHEET

Stop profile for dry lining

12,5 mm PB

Item no. 3785



Status: 25.06.2024 | 12:06

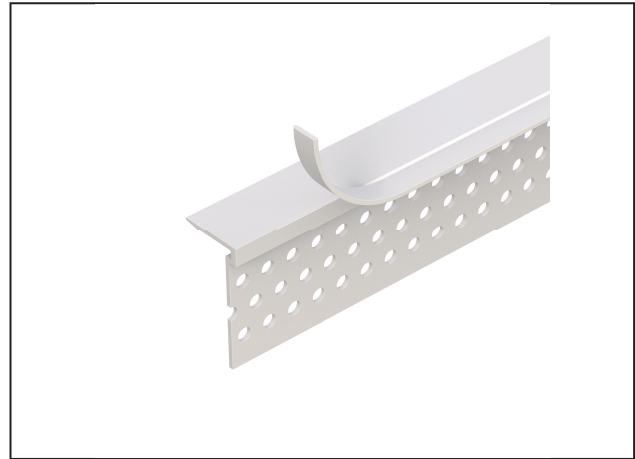
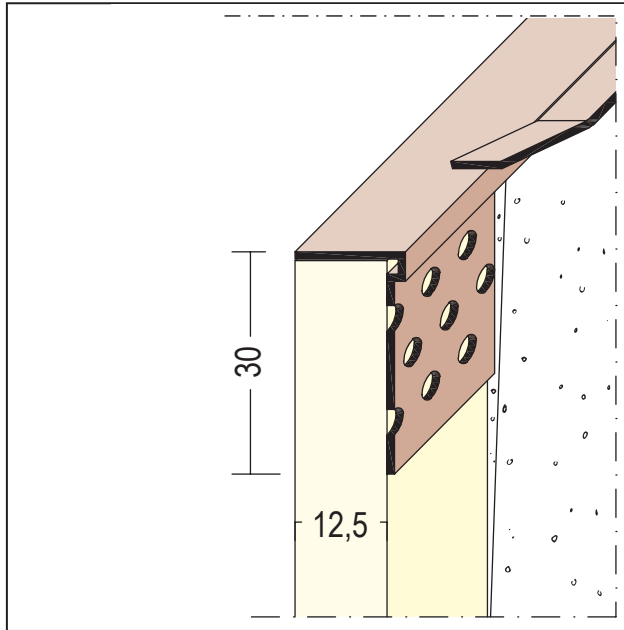

Designation	Stop profile for dry lining 12,5 mm PB
Description	“Göppinger profile” made of PVC for creating single edges at plastered junctions, e.g. sliding ceiling and wall connections. Also available with removable protective strips for guard building elements against dirt. Profiles must also be fastened with clips.
Product area	Internal construction
Product category	Filler profiles
Plaster thickness	2 mm
Material	Hard PVC
GK/Plate	12,5 mm
Product length	305 cm
Productcolor	10, white
Treatment	All profiles must also be fastened with clips in order to avoid resetting.
Packaging Unit	50 PCS / 80 BOX

This product data sheet corresponds to the current state of development of our products and loses its validity upon publication of a new edition. Make sure you are using the latest edition of this information. Warranty and liability are based on delivery according to our general Terms and conditions. Please observe the application assembly and storage guidelines.

All statements without guarantee. Reserve technical changes. Product illustrations may differ from the delivery product. Tender specifications, installation instructions and performance declarations (if required by law) can be found on our homepage. Please respect the environment for a proper disposal!