

PRODUCT DATA SHEET

Corner bead for interior plaster

10 mm, angular edge

Item no. 9007



Status: 11.10.2024 | 12:10

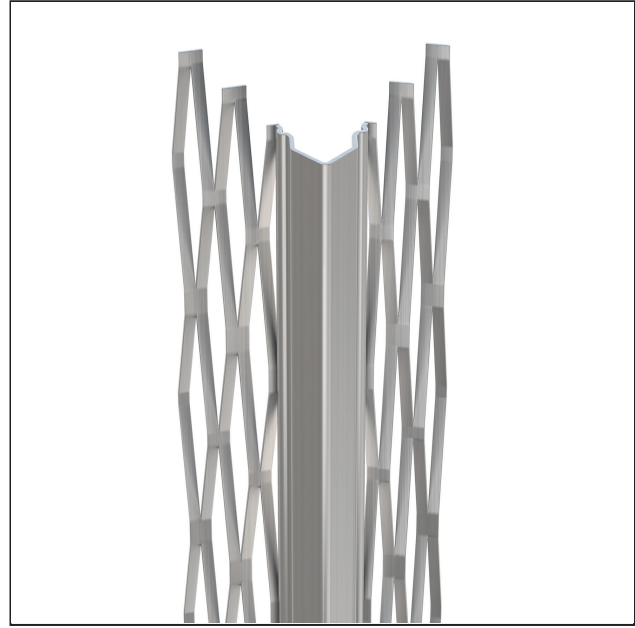
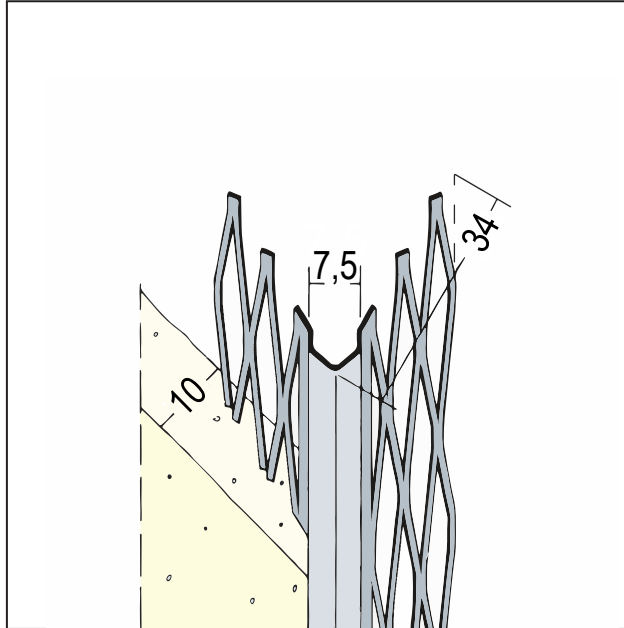

Designation	Corner bead for interior plaster 10 mm, angular edge
Description	Aluminium corner profile with sharp-tipped head, for interior plaster of 10 mm and thicker. Ideal for use with carpets and textile wall coverings. Plaster types: all mineral and putty-based plasters. Not for suitable for restoration plaster. Stainless steel profiles must be installed in commercial kitchens, other damp areas, swimming pools or halls, and when using restoration plaster.
Product area	Internal plastering
Product category	Corner profiles
Types of mortar	Lehmputz, Insulating plaster, Gypsum mortars and mortars containing gypsum, Attachment mortar
Plaster thickness	10 mm
Material	Aluminum natural
Material thickness	0,56 mm
Standard EN	EN 13658-1
Product length	260 cm; 275 cm; 300 cm
Leg length	34 mm
Reaction to fire (R2F)	A1
Packaging Unit	25 PCS / 81 BUN
Leaflet	* Leaflet Planning and Application of Metallic Plaster Profiles; Publisher: European Trade Association Europrofiles, www.europrofiles.com * Leaflet Planning and Application of Metallic Plaster Profiles; Publisher: European Trade Association Europrofiles, www.europrofiles.com * Leaflet Winter Construction Sites; Publisher: Bundesverband der Gipsindustrie e.V., www.gips.de

PRODUCT DATA SHEET

Corner bead for interior plaster

10 mm, angular edge

Item no. 9007



This product data sheet corresponds to the current state of development of our products and loses its validity upon publication of a new edition. Make sure you are using the latest edition of this information. Warranty and liability are based on delivery according to our general Terms and conditions. Please observe the application assembly and storage guidelines.

All statements without guarantee. Reserve technical changes. Product illustrations may differ from the delivery product. Tender specifications, installation instructions and performance declarations (if required by law) can be found on our homepage. Please respect the environment for a proper disposal!